

DEC 13 2019

Corners to be Indexed

E1/4 29-107-42

STATE OF MINNESOTA, } ss.
COUNTY OF MURRAY, }

I hereby certify that the within Instrument was filed in this office for record on the 13TH day of DECEMBER, A.D. 20 19 at 9:00 o'clock A. M., and was duly recorded as Document No. _____

I hereby certify that this document and the data contained herein was prepared by me or under my direct supervision.

Aug 14 2019
Date

Evelyn C. Larson
County Recorder

Daniel L. Bueltel
License No. 43844

CERTIFICATE OF LOCATION OF GOVERNMENT CORNER

Land survey monuments situated in Section 29, Township 107, Range 42, 5TH P.M.

STATE OF MINNESOTA, County of MURRAY

STATEMENT OF EVIDENCE:

- 1861 - Original Government Survey
- 1934 - Murray County Highway Department set concrete block at corner.
- 2015 - Murray County Highway Department found stone and irons at corner.



- FOUND MONUMENT
- SET MONUMENT

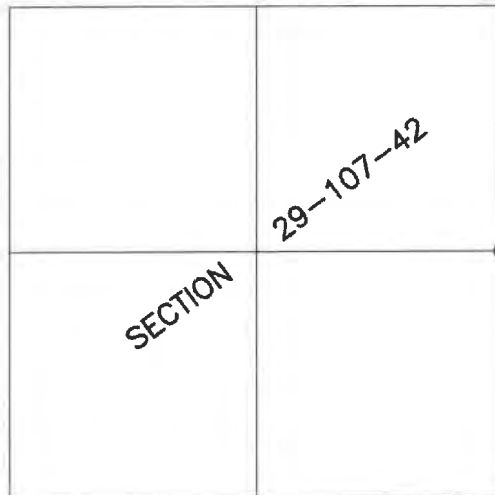

N:171542.316
E:463907.488
5/8" IRON
W/SEAL #43844

Minnesota State Plane Coordinate
System Murray County Datum NAD83 (1996)

Statement of Evidence

E1/4 29-107-42

In 1861, L.G.M. Fletcher did the original subdivision of the township.

In 1934, the Murray County Highway Department set a concrete block at the corner.

On June 15, 2015, Bueltel-Moseng Land Surveying found a 5/8" iron stake under the north side of rock. They set a 3/8" iron over the 5/8" iron.

On July 24, 2019, Bueltel-Moseng dug with backhoe. We found a 3/4" iron. We removed the iron and continued digging. We found a stone 1'± below surface. We removed the stone and continued to dig. We did not find anything else. We held to the center of the stone at the corner.

On August 13, 2019, Bueltel-Moseng Land Surveying set a 5/8" iron with seal #43844 at the corner. It is in the center of the road and in line with the fence to the west.